

# **A46 Newark Bypass TR010065/APP/5.2**

## **5.2 Consultation Report Annexes**

### **Annex L: Targeted Non-Statutory Consultation Letters and Materials**

APFP Regulation 5(2)(q)

Planning Act 2008

Infrastructure Planning (Applications: Prescribed Forms and  
Procedure) Regulations 2009

Volume 5

April 2024

Infrastructure Planning

Planning Act 2008

**The Infrastructure Planning  
(Applications: Prescribed Forms  
and Procedure) Regulations 2009**

**A46 Newark Bypass**

Development Consent Order 202[x]

---

**CONSULTATION REPORT ANNEXES**

**ANNEX L: TARGETED NON-STATUTORY CONSULTATION LETTERS  
AND MATERIALS**

---

<b>Regulation Number:</b>	Regulation 5(2)(q)
<b>Planning Inspectorate Scheme Reference</b>	TR010065
<b>Application Document Reference</b>	TR010065/APP/5.2
<b>Author:</b>	A46 Newark Bypass Project Team, National Highways

<b>Version</b>	<b>Date</b>	<b>Status of Version</b>
Rev 1	April 2024	DCO Application

## **Contents - Annex L**

### **L.1. – Targeted Non-Statutory Consultation Letter and Materials**

Our ref: TR010065/S42(1)(d)Cat1&2/March/2023

National Highways  
2 Colmore Square  
Birmingham  
B4 6BN

Tel: 0300 123 5000  
14 March 2023

Dear 

## **A46 Newark Bypass – Targeted Consultation**

We're undertaking a targeted consultation on updates to our proposals on the A46 Newark Bypass scheme that have occurred since our statutory consultation. The targeted consultation will run until **11.59pm on the 16 April 2023**.

### **Updates to our proposals**

As you're aware, we recently carried out our statutory consultation from 26 October 2022 to 12 December 2022. Since then, we've considered feedback received and updated our proposals to accommodate updates in six areas of our scheme.

These updates relate to additional land requirements and a design change at Winthorpe roundabout. We're continuing to develop our design and carry out assessments on the scheme. The proposed updates are:

#### **1) Langford Hall access road**

Following consultation feedback relating to impacted access routes, the proposed scheme boundary (also referred to as the 'draft Order Limits' or 'red line boundary') has been altered near to Langford Hall. The design of the proposed access route is still in development, however additional land requirements have been identified.

This proposed update can be seen at location 1 in the enclosed **Revised Draft Order Limits Plan**.

#### **2) Winthorpe roundabout**

Following consultation feedback and ongoing stakeholder engagement, the Winthorpe roundabout layout has been amended. To improve flows, the A46 traffic would be directed around the roundabout, with the northbound traffic from the Friendly Farmer roundabout passing through the middle. A signalised walking and cycling route would be provided across the junction between the A1133 and Drove Lane.

This proposed update can be seen at location 2 in the enclosed **Revised Draft Order Limits Plan**.

#### **3) Hargon Lane**

Following consultation feedback, the proposed scheme boundary has been altered along part of Hargon Lane. This would enable any works and/or rights required to connect the

current footpath on Hargon Lane with a new walking and cycling route proposed across Winthorpe roundabout between the A1133 and Drove Lane.

This proposed update can be seen at location 3 in the enclosed **Revised Draft Order Limits Plan**.

#### **4) Kelham/Averham floodplain compensation area**

Following further design development and engagement with local stakeholders, the proposed scheme boundary has been altered to include new land parcels identified for use as floodplain compensation areas, including land within the Kelham Conservation Area.

This proposed update can be seen at location 4 in the enclosed **Revised Draft Order Limits Plan**.

#### **5) Farndon bridleway (BW2) temporary diversion**

Following consultation feedback, the proposed scheme boundary has been altered to enable an alternative route to be used as a temporary bridleway diversion during construction.

This proposed update can be seen at location 5 in the enclosed **Revised Draft Order Limits Plan**.

#### **6) Farndon temporary construction holding area**

Following feedback from local stakeholders, the proposed scheme boundary has been altered to include additional land for temporary use as a vehicle holding area during construction.

This proposed update can be seen at location 6 in the enclosed **Revised Draft Order Limits Plan**.

### **Environmental Impact Assessment (EIA)**

The above updates will be assessed as part of our ongoing EIA process and will be reported within the Environmental Statement that will be submitted as part of the Development Consent Order (DCO) application.

Initial assessments indicate that the works in the Kelham Conservation Area, both during and after construction, are unlikely to result in any significant adverse effects to the character and appearance of the Conservation Area. This is due to the temporary nature of the construction works, and the reinstatement of the field to arable use once works are complete.

### **Targeted consultation materials**

We've enclosed targeted consultation materials that show the areas in which the proposed updates are located, including:

- **Revised Draft Order Limits Plan** – showing the full extent of the scheme boundary and the locations of the proposed updates
- **Revised Draft Order Limited – Area Plans** – showing a larger version of the area for each proposed update

- **Land Interest Plan(s)** - showing the land the proposed scheme will use (whether permanently or temporarily) that we believe you have an interest in

Copies of additional or accessible versions of our targeted consultation materials are available upon request from our project team, there may be a charge applied in certain cases to cover the cost of printing and postage. Copies of previous statutory consultation documents and plans are available on our scheme webpage.

Our webpage provides scheme information and can be accessed using the following web address: [www.nationalhighways.co.uk/a46-newark-bypass](http://www.nationalhighways.co.uk/a46-newark-bypass)

You can also use the scheme webpage to sign up to receive latest news and updates via email.

### **Why we are writing to you**

We invite you to look at the enclosed documents and take this opportunity to share your views and provide feedback on the proposed updates by **11.59pm on 16 April 2023**.

During the pre-application process, we must consult with a variety of persons and organisations about our proposed application in accordance with the requirements of the Planning Act 2008 (as amended) (the 2008 Act).

As defined under Section 44 of the 2008 Act, we believe that you may have a Category 1&2 interest in land in the area of the scheme that is proposed to be acquired and/or otherwise used by the scheme. We refer to "land" throughout this letter, and this extends to property.

This could mean you are:

- An owner, lessee, tenant or occupier of this land
- or
- You have another type of interest in this land, or have power to sell and convey it, or to release it

The enclosed targeted consultation documents detail where we understand your land is situated in relation to the proposed scheme.

We want to use this targeted consultation to allow you to tell us about the potential impacts that our scheme may have on your land/interest in land. We also want to work with you to identify ways in which the scheme could reduce these impacts as far as reasonably possible.

We can do that more effectively if we fully understand how you use the land and how our scheme will affect that use. You may also wish to consider whether your interests in any surrounding land not acquired/used by the scheme will be affected.

### **Response methods**

You can respond to our targeted consultation by sending any comments you have to:

- **A46newarkbypass@nationalhighways.co.uk**
- **Freepost A46 NEWARK BYPASS**

All responses should be submitted by **11.59pm on 16 April 2023**.

When providing any feedback, **please reference the update numbers shown** on the enclosed targeted consultation materials.

## **The consenting process**

The scheme is identified as a Nationally Significant Infrastructure Project (NSIP) under the 2008 Act. This means we're required to make an application for a DCO to get the consent we need to build the scheme.

Our DCO application will be made to the Planning Inspectorate, who will appoint an Examining Authority to examine the application. After the examination the Examining Authority make a recommendation to the Secretary of State, who will decide whether the application is granted.

We continue to assess comments received during the statutory consultation period, and will assess comments received during this targeted consultation, and prepare documents for the submission of a DCO application in summer 2023.

Further information about this process and DCOs can be found on the Planning Inspectorate's National Infrastructure Planning website: [infrastructure.planninginspectorate.gov.uk](https://infrastructure.planninginspectorate.gov.uk)

If you have any queries about this correspondence, the proposals or the targeted consultation, please do not hesitate to contact our project team using the details provided below.

Yours sincerely,

**Philip Boffey**  
**Senior Project Manager for the A46 Newark Bypass**  
Email: [A46newarkbypass@nationalhighways.co.uk](mailto:A46newarkbypass@nationalhighways.co.uk)  
Tel: 0300 123 5000

### **Enc.**

- Revised Draft Order Limits Plan
- Revised Draft Order Limited – Area Plans

Area Plan1 – Langford Hall access road

Area Plan 2 – Winthorpe roundabout

Area Plan 3 – Hargon Lane

Area Plan 4 – Kelham/Averham floodplain compensation area

Area Plan 5 – Farndon bridleway (BW2) temporary diversion

Area Plan 6 – Farndon temporary construction holding area

- Land Interest Plan(s)

Our ref: TR010065/S42(1)(d)Cat3/March/2023

National Highways  
2 Colmore Square  
Birmingham  
B4 6BN

Tel: 0300 123 5000  
14 March 2023

Dear 

## **A46 Newark Bypass – Targeted Consultation**

We're undertaking a targeted consultation on updates to our proposals on the A46 Newark Bypass scheme that have occurred since our statutory consultation. The targeted consultation will run until **11.59pm on the 16 April 2023**.

### **Updates to our proposals**

As you're aware, we recently carried out our statutory consultation from 26 October 2022 to 12 December 2022. Since then, we've considered feedback received and updated our proposals to accommodate updates in six areas of our scheme.

These updates relate to additional land requirements and a design change at Winthorpe roundabout. We're continuing to develop our design and carry out assessments on the scheme. The proposed updates are:

#### **1) Langford Hall access road**

Following consultation feedback relating to impacted access routes, the proposed scheme boundary (also referred to as the 'draft Order Limits' or 'red line boundary') has been altered near to Langford Hall. The design of the proposed access route is still in development, however additional land requirements have been identified.

This proposed update can be seen at location 1 in the enclosed **Revised Draft Order Limits Plan**.

#### **2) Winthorpe roundabout**

Following consultation feedback and ongoing stakeholder engagement, the Winthorpe roundabout layout has been amended. To improve flows, the A46 traffic would be directed around the roundabout, with the northbound traffic from the Friendly Farmer roundabout passing through the middle. A signalised walking and cycling route would be provided across the junction between the A1133 and Drove Lane.

This proposed update can be seen at location 2 in the enclosed **Revised Draft Order Limits Plan**.

#### **3) Hargon Lane**

Following consultation feedback, the proposed scheme boundary has been altered along part of Hargon Lane. This would enable any works and/or rights required to connect the



current footpath on Hargon Lane with a new walking and cycling route proposed across Winthorpe roundabout between the A1133 and Drove Lane.

This proposed update can be seen at location 3 in the enclosed **Revised Draft Order Limits Plan**.

#### **4) Kelham/Averham floodplain compensation area**

Following further design development and engagement with local stakeholders, the proposed scheme boundary has been altered to include new land parcels identified for use as floodplain compensation areas, including land within the Kelham Conservation Area.

This proposed update can be seen at location 4 in the enclosed **Revised Draft Order Limits Plan**.

#### **5) Farndon bridleway (BW2) temporary diversion**

Following consultation feedback, the proposed scheme boundary has been altered to enable an alternative route to be used as a temporary bridleway diversion during construction.

This proposed update can be seen at location 5 in the enclosed **Revised Draft Order Limits Plan**.

#### **6) Farndon temporary construction holding area**

Following feedback from local stakeholders, the proposed scheme boundary has been altered to include additional land for temporary use as a vehicle holding area during construction.

This proposed update can be seen at location 6 in the enclosed **Revised Draft Order Limits Plan**.

### **Environmental Impact Assessment (EIA)**

The above updates will be assessed as part of our ongoing EIA process and will be reported within the Environmental Statement that will be submitted as part of the Development Consent Order (DCO) application.

Initial assessments indicate that the works in the Kelham Conservation Area, both during and after construction, are unlikely to result in any significant adverse effects to the character and appearance of the Conservation Area. This is due to the temporary nature of the construction works, and the reinstatement of the field to arable use once works are complete.

### **Targeted consultation materials**

We have enclosed targeted consultation materials that show the areas in which the proposed updates are located, including:

- **Revised Draft Order Limits Plan** – showing the full extent of the scheme boundary and the locations of the proposed updates
- **Revised Draft Order Limited – Area Plans** – showing a larger version of the area for each proposed update

Copies of additional or accessible versions of our targeted consultation materials are available upon request from our project team, there may be a charge applied in certain cases to cover the cost of printing and postage. Copies of previous statutory consultation documents and plans are available on our scheme webpage.

Our webpage provides scheme information and can be accessed using the following web address: **[www.nationalhighways.co.uk/a46-newark-bypass](http://www.nationalhighways.co.uk/a46-newark-bypass)**

You can also use the scheme webpage to sign up to receive latest news and updates via email.

### **Why we are writing to you**

We invite you to look at the enclosed documents and take this opportunity to share your views and provide feedback on the updates by **11.59pm on 16 April 2023**.

During the pre-application process, we must consult with a variety of persons and organisations about our proposed application in accordance with the requirements of the Planning Act 2008 (as amended) (the 2008 Act).

We're writing you because we believe that you may/might be entitled to make a relevant claim due to the effects of construction and/or operation of the new road if the DCO for the proposed scheme were to be made and implemented.

You may be able to claim compensation under Section 152 of the Planning Act 2008, under Section 10 of the Compulsory Purchase Act 1965 or under Part I of the Land Compensation Act 1973.

A relevant claim is one which either relates to:

- a right that you may have is interfered with by the scheme such as a right of way;
- a reduction in the value of your property which is adjacent to the scheme and where no rights are affected but because of physical factors arising from the scheme such as noise or lighting – often referred to as Part 1 Claims; or
- where a claim in nuisance may arise.

This is part of a precautionary approach that we're taking to potential interests in land or property in the area of the scheme. Any claims relating to these interests will need to be made and substantiated (but only after the scheme if consented is constructed).

It's important to note that being consulted under this category does not confirm entitlement to a future claim. Entitlement to compensation is assessed by our professional valuers at the time that a claim is made. We recommend that you take professional advice before making any claim.

### **Response methods**

You can respond to our targeted consultation by sending any comments you have to:

- **[A46newarkbypass@nationalhighways.co.uk](mailto:A46newarkbypass@nationalhighways.co.uk)**
- **Freepost A46 NEWARK BYPASS**

All responses should be submitted by **11.59pm on 16 April 2023**.

When providing any feedback, **please reference the update numbers shown** on the enclosed targeted consultation materials.

## **The consenting process**

The scheme is identified as a Nationally Significant Infrastructure Project (NSIP) under the 2008 Act. This means we're required to make an application for a DCO to get the consent we need to build the scheme.

Our DCO application will be made to the Planning Inspectorate, who will appoint an Examining Authority to examine the application. After the examination the Examining Authority make a recommendation to the Secretary of State, who will decide whether the application is granted.

We continue to assess comments received during the statutory consultation period, and will assess comments received during this targeted consultation, and prepare documents for the submission of a DCO application in summer 2023.

Further information about this process and DCOs can be found on the Planning Inspectorate's National Infrastructure Planning website: [infrastructure.planninginspectorate.gov.uk](https://infrastructure.planninginspectorate.gov.uk)

If you have any queries about this correspondence, the proposals or the targeted consultation, please do not hesitate to contact our project team using the details provided below.

Yours sincerely,

**Philip Boffey**  
**Senior Project Manager for the A46 Newark Bypass**  
Email: [A46newarkbypass@nationalhighways.co.uk](mailto:A46newarkbypass@nationalhighways.co.uk)  
Tel: 0300 123 5000

### **Enc.**

- Revised Draft Order Limits Plan
- Revised Draft Order Limited – Area Plans

Area Plan 1 – Langford Hall access road

Area Plan 2 – Winthorpe roundabout

Area Plan 3 – Hargon Lane

Area Plan 4 – Kelham/Averham floodplain compensation area

Area Plan 5 – Farndon bridleway (BW2) temporary diversion

Area Plan 6 – Farndon temporary construction holding area

Our ref: TR010065/S42(1)(d)Cat1&2/April/2023

National Highways  
2 Colmore Square  
Birmingham  
B4 6BN



Tel: 0300 123 5000  
26 April 2023

Dear 

## **A46 Newark Bypass – Targeted Consultation**

We're undertaking a targeted consultation on updates to our proposals on the A46 Newark Bypass scheme that have occurred since our statutory consultation. The targeted consultation will run until **11.59pm on the 2 June 2023**.

### **Updates to our proposals**

As you're aware, we recently carried out our statutory consultation from 26 October 2022 to 12 December 2022. Since then, we've considered feedback received and updated our proposals to accommodate updates in six areas of our scheme.

These updates relate to additional land requirements and a design change at Winthorpe roundabout. We're continuing to develop our design and carry out assessments on the scheme. The proposed updates are:

#### **1) Langford Hall access road**

Following consultation feedback relating to impacted access routes, the proposed scheme boundary (also referred to as the 'draft Order Limits' or 'red line boundary') has been altered near to Langford Hall. The design of the proposed access route is still in development, however additional land requirements have been identified.

This proposed update can be seen at location 1 in the enclosed **Revised Draft Order Limits Plan**.

#### **2) Winthorpe roundabout**

Following consultation feedback and ongoing stakeholder engagement, the Winthorpe roundabout layout has been amended. To improve flows, the A46 traffic would be directed around the roundabout, with the northbound traffic from the Friendly Farmer roundabout passing through the middle. A signalised walking and cycling route would be provided across the junction between the A1133 and Drove Lane.

This proposed update can be seen at location 2 in the enclosed **Revised Draft Order Limits Plan**.

#### **3) Hargon Lane**

Following consultation feedback, the proposed scheme boundary has been altered along part of Hargon Lane. This would enable any works and/or rights required to connect the

current footpath on Hargon Lane with a new walking and cycling route proposed across Winthorpe roundabout between the A1133 and Drove Lane.

This proposed update can be seen at location 3 in the enclosed **Revised Draft Order Limits Plan**.

#### **4) Kelham/Averham floodplain compensation area**

Following further design development and engagement with local stakeholders, the proposed scheme boundary has been altered to include new land parcels identified for use as floodplain compensation areas, including land within the Kelham Conservation Area.

This proposed update can be seen at location 4 in the enclosed **Revised Draft Order Limits Plan**.

#### **5) Farndon bridleway (BW2) temporary diversion**

Following consultation feedback, the proposed scheme boundary has been altered to enable an alternative route to be used as a temporary bridleway diversion during construction.

This proposed update can be seen at location 5 in the enclosed **Revised Draft Order Limits Plan**.

#### **6) Farndon temporary construction holding area**

Following feedback from local stakeholders, the proposed scheme boundary has been altered to include additional land for temporary use as a vehicle holding area during construction.

This proposed update can be seen at location 6 in the enclosed **Revised Draft Order Limits Plan**.

### **Environmental Impact Assessment (EIA)**

The above updates will be assessed as part of our ongoing EIA process and will be reported within the Environmental Statement that will be submitted as part of the Development Consent Order (DCO) application.

Initial assessments indicate that the works in the Kelham Conservation Area, both during and after construction, are unlikely to result in any significant adverse effects to the character and appearance of the Conservation Area. This is due to the temporary nature of the construction works, and the reinstatement of the field to arable use once works are complete.

### **Targeted consultation materials**

We've enclosed targeted consultation materials that show the areas in which the proposed updates are located, including:

- **Revised Draft Order Limits Plan** – showing the full extent of the scheme boundary and the locations of the proposed updates
- **Revised Draft Order Limited – Area Plans** – showing a larger version of the area for each proposed update

- **Land Interest Plan(s)** - showing the land the proposed scheme will use (whether permanently or temporarily) that we believe you have an interest in

Copies of additional or accessible versions of our targeted consultation materials are available upon request from our project team, there may be a charge applied in certain cases to cover the cost of printing and postage. Copies of previous statutory consultation documents and plans are available on our scheme webpage.

Our webpage provides scheme information and can be accessed using the following web address: [www.nationalhighways.co.uk/a46-newark-bypass](http://www.nationalhighways.co.uk/a46-newark-bypass)

You can also use the scheme webpage to sign up to receive latest news and updates via email.

### **Why we are writing to you**

We invite you to look at the enclosed documents and take this opportunity to share your views and provide feedback on the proposed updates by **11.59pm on 2 June 2023**.

During the pre-application process, we must consult with a variety of persons and organisations about our proposed application in accordance with the requirements of the Planning Act 2008 (as amended) (the 2008 Act).

As defined under Section 44 of the 2008 Act, we believe that you may have a Category 1&2 interest in land in the area of the scheme that is proposed to be acquired and/or otherwise used by the scheme. We refer to "land" throughout this letter, and this extends to property.

This could mean you are:

- An owner, lessee, tenant or occupier of this land
- or
- You have another type of interest in this land, or have power to sell and convey it, or to release it

The enclosed targeted consultation documents detail where we understand your land is situated in relation to the proposed scheme.

We want to use this targeted consultation to allow you to tell us about the potential impacts that our scheme may have on your land/interest in land. We also want to work with you to identify ways in which the scheme could reduce these impacts as far as reasonably possible.

We can do that more effectively if we fully understand how you use the land and how our scheme will affect that use. You may also wish to consider whether your interests in any surrounding land not acquired/used by the scheme will be affected.

### **Response methods**

You can respond to our targeted consultation by sending any comments you have to:

- **A46newarkbypass@nationalhighways.co.uk**
- **Freepost A46 NEWARK BYPASS**

All responses should be submitted by **11.59pm on 2 June 2023**.

When providing any feedback, **please reference the update numbers shown** on the enclosed targeted consultation materials.

## **The consenting process**

The scheme is identified as a Nationally Significant Infrastructure Project (NSIP) under the 2008 Act. This means we're required to make an application for a DCO to get the consent we need to build the scheme.

Our DCO application will be made to the Planning Inspectorate, who will appoint an Examining Authority to examine the application. After the examination the Examining Authority make a recommendation to the Secretary of State, who will decide whether the application is granted.

We continue to assess comments received during the statutory consultation period, and will assess comments received during this targeted consultation, and prepare documents for the submission of a DCO application in summer 2023.

Further information about this process and DCOs can be found on the Planning Inspectorate's National Infrastructure Planning website: **[infrastructure.planninginspectorate.gov.uk](https://infrastructure.planninginspectorate.gov.uk)**

If you have any queries about this correspondence, the proposals or the targeted consultation, please do not hesitate to contact our project team using the details provided below.

Yours sincerely,

**Philip Boffey**  
**Senior Project Manager for the A46 Newark Bypass**  
Email: [A46newarkbypass@nationalhighways.co.uk](mailto:A46newarkbypass@nationalhighways.co.uk)  
Tel: 0300 123 5000

### **Enc.**

- Revised Draft Order Limits Plan
- Revised Draft Order Limited – Area Plans

Area Plan1 – Langford Hall access road

Area Plan 2 – Winthorpe roundabout

Area Plan 3 – Hargon Lane

Area Plan 4 – Kelham/Averham floodplain compensation area

Area Plan 5 – Farndon bridleway (BW2) temporary diversion

Area Plan 6 – Farndon temporary construction holding area

- Land Interest Plan(s)

**From:** A46 Newark Bypass <A46NewarkBypass@nationalhighways.co.uk>  
**Sent:** 17 March 2023 10:47  
**To:** [REDACTED]@nottsc.gov.uk  
**Cc:** a46; A46 Newark Bypass  
**Subject:** A46 Newark Bypass - Targeted Consultation  
**Attachments:** Nottinghamshire County Council.pdf

Dear Sir/Madam,

I am writing to you on behalf of National Highways regarding the A46 Newark Bypass scheme.

We're undertaking a targeted consultation on updates to our proposals on the A46 Newark Bypass scheme that have occurred since the statutory consultation. The targeted consultation will run until 11.59pm on 16 April 2023. The information within this email has also been issued by post.

As you're aware, we recently carried out statutory consultation from 26 October to 12 December 2022. Since then, we've considered feedback received and updated our proposals to accommodate updates in six areas of our scheme. These updates relate to additional land requirements and a design change at Winthorpe roundabout.

Please find attached the following documents that provide more information:

- Letter explaining the targeted consultation and design updates in more detail
- Revised Draft Order Limits Plan – showing the full extent of the scheme boundary and the locations of the proposed updates
- Revised Draft Order Limited – Area Plans – showing a larger version of the area for each proposed update
- Land Interest Plan(s)

We continue to assess comments received during the statutory consultation period and will assess comments received during this targeted consultation as we prepare documents for the submission of a DCO application in summer 2023. Please note that the targeted consultation will run until 11.59pm on the 16 April 2023.

**Major Projects | Regional Investment Programme, Midlands**  
National Highways | 2 Colmore Square | Birmingham | B4 6BN  
[www.nationalhighways.co.uk](http://www.nationalhighways.co.uk)

This email may contain information which is confidential and is intended only for use of the recipient/s named above. If you are not an intended recipient, you are hereby notified that any copying, distribution, disclosure, reliance upon or other use of the contents of this email is strictly prohibited. If you have received this email in error, please notify the sender and destroy it.

**National Highways Limited | General enquiries: 0300 123 5000 | National Traffic Operations Centre, 3 Ridgeway, Quinton Business Park, Birmingham B32 1AF | <https://nationalhighways.co.uk> | [info@nationalhighways.co.uk](mailto:info@nationalhighways.co.uk)**



Our ref: TR010065/S42(1)(d)Cat1&2/April/2023

National Highways  
2 Colmore Square  
Birmingham  
B4 6BN

Tel: 0300 123 5000  
27 April 2023

Dear Sir/Madam

## **A46 Newark Bypass – Targeted Consultation – Deadline Extension**

### **Why we're writing to you**

We've recently written to you seeking your views on the A46 Newark Bypass scheme, as part of a targeted consultation by letter dated 15 March 2023 (ref.TR010065/S42(1)(d)/March/2023).

It has come to our attention that you may not have had the 28 days to respond to the consultation, due to the date the letter arrived with you. As a result of the delayed delivery, we're extending the deadline for you to provide a response to our consultation.

The revised deadline for responses to be submitted is by **11.59pm on 15 May 2023**.

If you have already responded to this consultation and do not wish to submit any further comments you do not need to take any further action.

### **Response methods**

You can respond to this statutory consultation by sending any comments you have to:

- **A46newarkbypass@nationalhighways.co.uk**
- **Freepost A46 NEWARK BYPASS**

### **Where you can get more information**

Our webpage provides current scheme information as well as historic information and can be accessed using the following web address: [www.nationalhighways.co.uk/a46-newark-bypass](http://www.nationalhighways.co.uk/a46-newark-bypass)

You can also use the scheme webpage to sign up to receive latest news and updates via email.

Copies of additional or accessible versions of our consultation materials are available upon request from our project team, they may be a charge applied in certain cases to cover the cost of printing and postage.

If you have any queries about this correspondence, the proposals or the consultations, please do not hesitate to contact our project team using the details provided below.

Yours sincerely

**Philip Boffey**  
**Senior Project Manager for the A46 Newark Bypass**  
Email: [A46newarkbypass@nationalhighways.co.uk](mailto:A46newarkbypass@nationalhighways.co.uk)  
Tel: 0300 123 50

Our ref: TR010065/S42(1)(d)Cat1&2/March2/2023

National Highways  
2 Colmore Square  
Birmingham  
B4 6BN

Tel: 0300 123 5000  
30 March 2023

Dear 

### **A46 Newark Bypass – Statutory Consultation**

We've recently written to you seeking your views on proposed updates to the A46 Newark Bypass scheme, as part of a targeted consultation. This is because you have recently been identified as a person with an interest in land that is within the updated scheme boundary (also referred to as the 'draft Order Limits' or 'red line boundary').

A copy of the targeted consultation letter and enclosures have been included again for your convenience.

#### **Why we are writing to you**

This letter provides information relating to a statutory consultation that we previously carried out on the scheme.

The statutory consultation period ran from 26 October 2022 to 12 December 2022 and presented proposals to widen 6.5km of the existing single carriageway to a dual carriageway, to provide two lanes in each direction between Farndon and Winthorpe roundabouts near Newark-on-Trent.

As you have recently been identified as having an interest in land within the updated scheme boundary, we would like to give you the opportunity to comment on the scheme as a whole, as you may not have had the opportunity to do so last year.

It is an important opportunity for you to share your views on our proposals and will enable us to take your views into account when developing and refining our proposals before we submit our Development Consent Order (DCO) application for the scheme.

Please refer to our consultation materials and use the contact details below to provide us with a response to our statutory consultation. When providing feedback please also consider the updates included as part of the targeted consultation.

#### **Why we are consulting with you**

During the pre-application process, we must consult with a variety of persons and organisations about our proposed application in accordance with the requirements of the Planning Act 2008 (as amended) (the 2008 Act).

As defined under Section 44 of the 2008 Act, we believe that you may have a Category 1 & 2 interest in land in the area of the scheme that is proposed to be acquired and / or otherwise used by the scheme, shown in the enclosed plans. This could mean you are:

- An owner, lessee, tenant or occupier of this land

or

- You have another type of interest in this land, or have power to sell and convey it, or to release it.

## **Statutory consultation materials**

We've enclosed a copy of our statutory consultation brochure, which provides information on the design for the scheme, as it was presented during the consultation held between October and December 2022.

To view the other statutory consultation materials from that time, listed below, please visit our scheme webpage at **[www.nationalhighways.co.uk/a46-newark-bypass](http://www.nationalhighways.co.uk/a46-newark-bypass)**

- Preliminary Environmental Information (PEI) Report
- Non-Technical Summary of the PEI Report
- General Arrangement Drawings
- Plan and Profile Drawings
- Fly-through video

Please note that the above materials are from the statutory consultation and as such do not reflect the updates set out in the targeted consultation. However, we've also provided a copy of the targeted consultation materials which includes a plan showing the updated proposed scheme boundary and a specific plan showing where we believe your land interest is.

We want to use this consultation to allow you to tell us about the potential impacts that our proposed scheme may have on your land / interest in land. We also want to work with you to identify ways in which the proposed scheme could reduce these impacts as far as reasonably possible.

We can do that more effectively if we fully understand how you use the land and how our scheme will affect that use. You may also wish to consider whether your interests in any surrounding land not acquired / used by the scheme will be affected.

Please refer to the enclosed consultation documents relevant to you personally, as well as our other consultation materials, and use the contact details provided near the end of this letter to provide us with a response to our consultation.

As the project is an Environmental Impact Assessment (EIA) development as defined by the Infrastructure Planning (Environmental Impact Assessment) Regulations 2017 (the EIA Regulations) we've prepared a PEI Report to help you understand the likely effects of our proposals. We will also submit an Environmental Statement with the application.

## **Landowner meetings**

To arrange an appointment with the project team please contact us using the details below to organise a time for us to speak to you directly. Please let us know if you would like to discuss any specific issues.

## **Response methods**

You can respond to this statutory consultation by sending any comments you have to:

- **[A46newarkbypass@nationalhighways.co.uk](mailto:A46newarkbypass@nationalhighways.co.uk)**
- **Freepost A46 NEWARK BYPASS**

All responses should be submitted by **11.59pm on 2 May 2023**.

## **Where you can get more information**

Our webpage provides current scheme information as well as historic information and can be accessed using the following web address: [www.nationalhighways.co.uk/a46-newark-bypass](http://www.nationalhighways.co.uk/a46-newark-bypass)

You can also use the scheme webpage to sign up to receive latest news and updates via email.

Copies of additional or accessible versions of our consultation materials are available upon request from our project team, there may be a charge applied in certain cases to cover the cost of printing and postage.

We've produced the following guidance about our road proposals and your property, including compulsory acquisition and compensation, which you can view on the scheme webpage:

- Your property and our road proposals
- Your property and discretionary purchase
- Your property and compulsory acquisition
- Your property and blight
- Your property and compensation or mitigation for the effects of our road proposal

## **The consenting process**

The scheme is identified as a Nationally Significant Infrastructure Project (NSIP) under the Planning Act 2008. This means we are required to make an application for a DCO to get the consent we need to build the scheme.

This application will be made to the Planning Inspectorate who will examine the application on behalf of the Secretary of State, to get consent to construct and operate the scheme. We intend to make our application for a DCO in summer 2023.

Further information about this process and DCOs can be found on the Planning Inspectorate's National Infrastructure Planning website: [infrastructure.planninginspectorate.gov.uk](http://infrastructure.planninginspectorate.gov.uk)

If you have any queries about this correspondence, the proposals or the consultations, please do not hesitate to contact our project team using the details provided below.

Yours sincerely

**Philip Boffey**  
**Senior Project Manager for the A46 Newark Bypass**

Email: [A46newarkbypass@nationalhighways.co.uk](mailto:A46newarkbypass@nationalhighways.co.uk)

Tel: 0300 123 5000

Enc.

- Targeted consultation letter and enclosures – reference TR010065/S42(1)(d) Cat1&2/March/2023
- Statutory consultation brochure

## Your data, your rights

In line with UK Data Protection legislation, National Highways are required to explain to you – consultees, stakeholders and customers – how your personal data will be used and stored.

National Highways adheres to the government's consultation principles, the Planning Act 2008 and the Highways Act 1980 as required and may collect personal data to help shape development of highways schemes.

Personal data collected by the project team will be processed and retained by National Highways and its appointed contractors until the scheme is complete.

In some instances consultation responses may also be sent to the Planning Inspectorate. To view the Planning Inspectorate's information relating to Data Protection at Examination events please visit: **[infrastructure.planninginspectorate.gov.uk/help/privacy-notice](https://infrastructure.planninginspectorate.gov.uk/help/privacy-notice)**

Under the GDPR regulations you have the following rights:

- Right of access to the data (Subject Access Request)
- Right for the rectification of errors
- Right to erasure of personal data – this is not an absolute right under the legislation
- Right to restrict processing or to object to processing
- Right to data portability

If, at any point, National Highways plans to process the personal data we hold for a purpose other than that for which it was originally collected, we will tell you what that other purpose is. We will do this prior to any further processing taking place and we will include any relevant additional information, including your right to object to that further processing.

You have the right to lodge a complaint with the supervisory authority, the Information Commissioners Office.

If you'd like more information about how we manage data, or a copy of our privacy notice, please contact: **[DataProtectionAdvice@nationalhighways.co.uk](mailto:DataProtectionAdvice@nationalhighways.co.uk)**

Our ref: TR010065/S42(1)(d)Cat3/March2/2023

National Highways  
2 Colmore Square  
Birmingham  
B4 6BN

Tel: 0300 123 5000  
30 March 2023

Dear 

## **A46 Newark Bypass – Statutory Consultation**

We've recently written to you seeking your views on proposed updates to the A46 Newark Bypass scheme, as part of a targeted consultation. This is because you have recently been identified as a person with an interest in land that is within the updated scheme boundary (also referred to as the 'draft Order Limits' or 'red line boundary').

A copy of the targeted consultation letter and enclosures have been included again for your convenience.

### **Why we are writing to you**

This letter provides information relating to a statutory consultation that we previously carried out on the scheme.

The statutory consultation period ran from 26 October 2022 to 12 December 2022 and presented proposals to widen 6.5km of the existing single carriageway to a dual carriageway, to provide two lanes in each direction between Farndon and Winthorpe roundabouts near Newark-on-Trent.

As you have recently been identified as having an interest in land within the updated scheme boundary, we would like to give you the opportunity to comment on the scheme as a whole, as you may not have had the opportunity to do so last year.

It is an important opportunity for you to share your views on our proposals and will enable us to take your views into account when developing and refining our proposals before we submit our Development Consent Order (DCO) application for the scheme.

Please refer to our consultation materials and use the contact details below to provide us with a response to our statutory consultation. When providing feedback please also consider the updates included as part of the targeted consultation.

### **Why we are consulting with you**

During the pre-application process, we must consult with a variety of persons and organisations about our proposed application in accordance with the requirements of the Planning Act 2008 (as amended) (the 2008 Act).

We're writing you because we believe that you may/might be entitled to make a relevant claim due to the effects of construction and/or operation of the new road if the DCO for the proposed scheme were to be made and implemented.

You may be able to claim compensation under Section 152 of the Planning Act 2008, under Section 10 of the Compulsory Purchase Act 1965 or under Part I of the Land Compensation Act 1973. A relevant claim is one which either relates to:

- a right that you may have is interfered with by the scheme such as a right of way;
- a reduction in the value of your property which is adjacent to the scheme and where no rights are affected but because of physical factors arising from the scheme such as noise or lighting – often referred to as Part 1 Claims; or
- where a claim in nuisance may arise.

This is part of a precautionary approach that we're taking to potential interests in land or property in the area of the scheme. Any claims relating to these interests will need to be made and substantiated (but only after the scheme if consented is constructed).

It's important to note that being consulted under this category does not confirm entitlement to a future claim. Entitlement to compensation is assessed by our professional valuers at the time that a claim is made. We recommend that you take professional advice before making any claim.

### **Statutory consultation materials**

We've enclosed a copy of our statutory consultation brochure, which provides information on the design for the scheme, as it was presented during the consultation held between October and December 2022.

To view the other statutory consultation materials from that time, listed below, please visit our scheme webpage at [www.nationalhighways.co.uk/a46-newark-bypass](http://www.nationalhighways.co.uk/a46-newark-bypass)

- Preliminary Environmental Information (PEI) Report
- Non-Technical Summary of the PEI Report
- General Arrangement Drawings
- Plan and Profile Drawings
- Fly-through video

Please note that the above materials are from the statutory consultation and as such do not reflect the updates set out in the targeted consultation. However, we've also provided a copy of the targeted consultation materials which includes a plan showing the updated proposed scheme boundary and a specific plan showing where we believe your land interest is.

We want to use this consultation to allow you to tell us about the potential impacts that our proposed scheme may have on your land / interest in land. We also want to work with you to identify ways in which the proposed scheme could reduce these impacts as far as reasonably possible.

We can do that more effectively if we fully understand how you use the land and how our scheme will affect that use. You may also wish to consider whether your interests in any surrounding land not acquired / used by the scheme will be affected.

Please refer to the enclosed consultation documents relevant to you personally, as well as our other consultation materials, and use the contact details provided near the end of this letter to provide us with a response to our consultation.

As the project is an Environmental Impact Assessment (EIA) development as defined by the Infrastructure Planning (Environmental Impact Assessment) Regulations 2017 (the EIA Regulations) we've prepared a PEI Report to help you understand the likely effects of our proposals. We will also submit an Environmental Statement with the application.

### **Landowner meetings**

To arrange an appointment with the project team please contact us using the details below to organise a time for us to speak to you directly. Please let us know if you would like to discuss any specific issues.

## **Response methods**

You can respond to this statutory consultation by sending any comments you have to:

- **A46newarkbypass@nationalhighways.co.uk**
- **Freepost A46 NEWARK BYPASS**

All responses should be submitted by **11.59pm on 2 May 2023**.

## **Where you can get more information**

Our webpage provides current scheme information as well as historic information and can be accessed using the following web address: [www.nationalhighways.co.uk/a46-newark-bypass](http://www.nationalhighways.co.uk/a46-newark-bypass)

You can also use the scheme webpage to sign up to receive latest news and updates via email.

Copies of additional or accessible versions of our consultation materials are available upon request from our project team, they may be a charge applied in certain cases to cover the cost of printing and postage.

We've produced the following guidance about our road proposals and your property, including compulsory acquisition and compensation, which you can view on the scheme webpage:

- Your property and our road proposals
- Your property and discretionary purchase
- Your property and compulsory acquisition
- Your property and blight
- Your property and compensation or mitigation for the effects of our road proposals

## **The consenting process**

The scheme is identified as a Nationally Significant Infrastructure Project (NSIP) under the Planning Act 2008. This means we are required to make an application for a DCO to get the consent we need to build the scheme.

This application will be made to the Planning Inspectorate who will examine the application on behalf of the Secretary of State, to get consent to construct and operate the scheme. We intend to make our application for a DCO in summer 2023.

Further information about this process and DCOs can be found on the Planning Inspectorate's National Infrastructure Planning website: **[infrastructure.planninginspectorate.gov.uk](http://infrastructure.planninginspectorate.gov.uk)**

If you have any queries about this correspondence, the proposals or the consultations, please do not hesitate to contact our project team using the details provided below.

Yours sincerely

**Philip Boffey**  
**Senior Project Manager for the A46 Newark Bypass**  
Email: [A46newarkbypass@nationalhighways.co.uk](mailto:A46newarkbypass@nationalhighways.co.uk)  
Tel: 0300 123 5000



Enc.

- Targeted consultation letter and enclosures – ref. TR010065/S42(1)(d) Cat1&2/March/2023
- Statutory consultation brochure

## **Your data, your rights**

In line with UK Data Protection legislation, National Highways are required to explain to you – consultees, stakeholders and customers – how your personal data will be used and stored.

National Highways adheres to the government’s consultation principles, the Planning Act 2008 and the Highways Act 1980 as required and may collect personal data to help shape development of highways schemes.

Personal data collected by the project team will be processed and retained by National Highways and its appointed contractors until the scheme is complete.

In some instances consultation responses may also be sent to the Planning Inspectorate. To view the Planning Inspectorate’s information relating to Data Protection at Examination events please visit: **[infrastructure.planninginspectorate.gov.uk/help/privacy-notice](https://infrastructure.planninginspectorate.gov.uk/help/privacy-notice)**

Under the GDPR regulations you have the following rights:

- Right of access to the data (Subject Access Request)
- Right for the rectification of errors
- Right to erasure of personal data – this is not an absolute right under the legislation
- Right to restrict processing or to object to processing
- Right to data portability

If, at any point, National Highways plans to process the personal data we hold for a purpose other than that for which it was originally collected, we will tell you what that other purpose is. We will do this prior to any further processing taking place and we will include any relevant additional information, including your right to object to that further processing.

You have the right to lodge a complaint with the supervisory authority, the Information Commissioners Office.

If you’d like more information about how we manage data, or a copy of our privacy notice, please contact: **[DataProtectionAdvice@nationalhighways.co.uk](mailto:DataProtectionAdvice@nationalhighways.co.uk)**

Our ref: TR010065/ [REDACTED]

National Highways  
2 Colmore Square  
Birmingham  
B4 6BN

Tel: 0300 123 5000  
26 April 2023

Dear [REDACTED]

## **A46 Newark Bypass – Statutory Consultation – Deadline Extension**

### **Why we're writing to you**

We've recently written to you seeking your views on the A46 Newark Bypass scheme, as part of a statutory consultation (letter reference TR010065/S42(1)(d)Cat3/March2/2023).

It has come to our attention that you may not have had the statutory 28 days to respond to the consultation, due to the date the letter arrived with you. As a result of the delayed delivery, we're extending the consultation deadline.

The revised deadline for responses to be submitted is by **11.59pm on 12 May 2023**.

### **Response methods**

You can respond to this statutory consultation by sending any comments you have to:

- **A46newarkbypass@nationalhighways.co.uk**
- **Freepost A46 NEWARK BYPASS**

### **Where you can get more information**

Our webpage provides current scheme information as well as historic information and can be accessed using the following web address: [www.nationalhighways.co.uk/a46-newark-bypass](http://www.nationalhighways.co.uk/a46-newark-bypass)

You can also use the scheme webpage to sign up to receive latest news and updates via email.

Copies of additional or accessible versions of our consultation materials are available upon request from our project team, they may be a charge applied in certain cases to cover the cost of printing and postage.

If you have any queries about this correspondence, the proposals or the consultations, please do not hesitate to contact our project team using the details provided below.

Yours sincerely

**Philip Boffey**  
**Senior Project Manager for the A46 Newark Bypass**  
Email: [A46newarkbypass@nationalhighways.co.uk](mailto:A46newarkbypass@nationalhighways.co.uk)  
Tel: 0300 123 5000

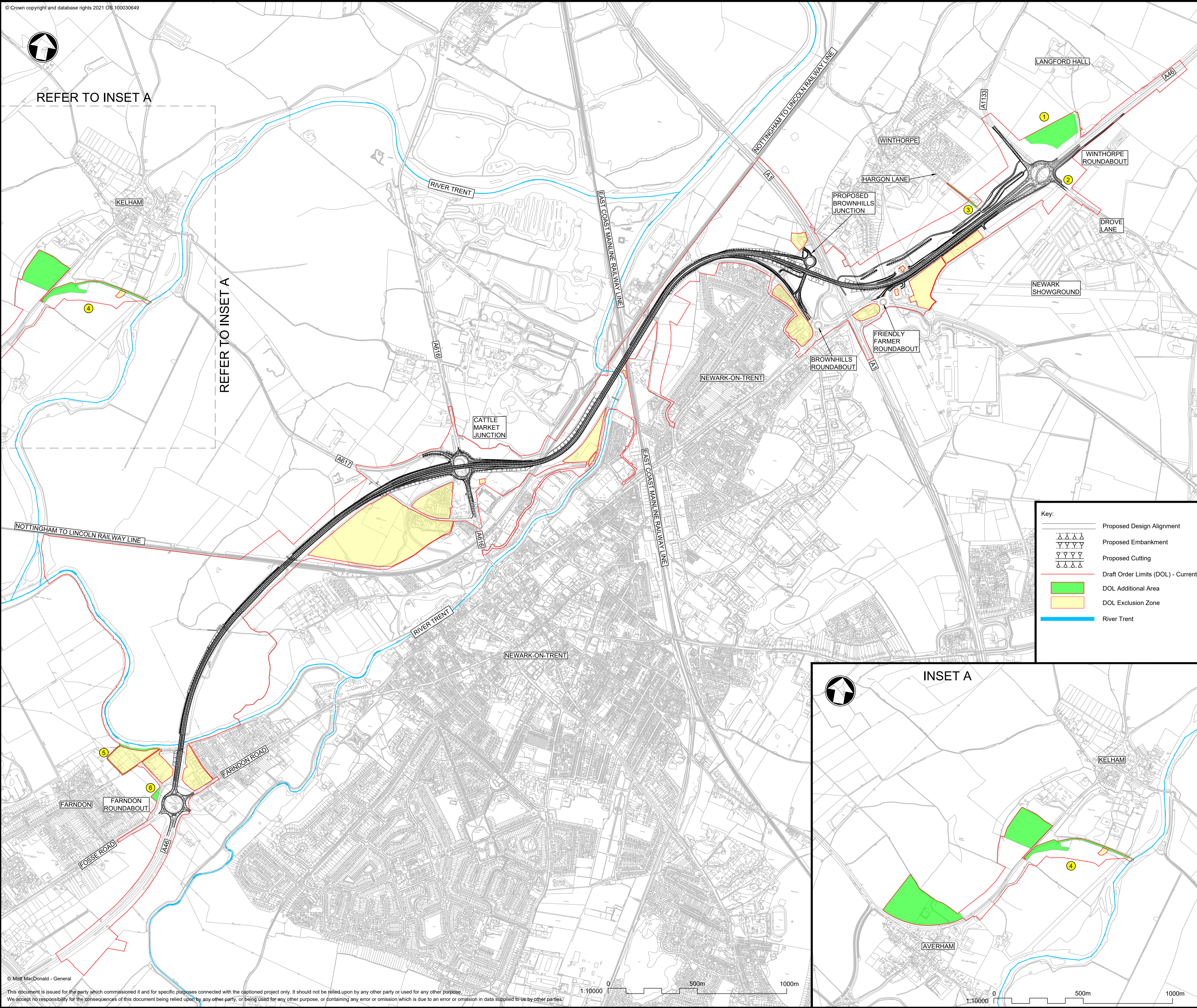

REFER TO INSET A

REFER TO INSET A

**Key:**

- Proposed Design Alignment
- Proposed Embankment
- Proposed Cutting
- Draft Order Limits (DOL) - Current
- DOL Additional Area
- DOL Exclusion Zone
- River Trent

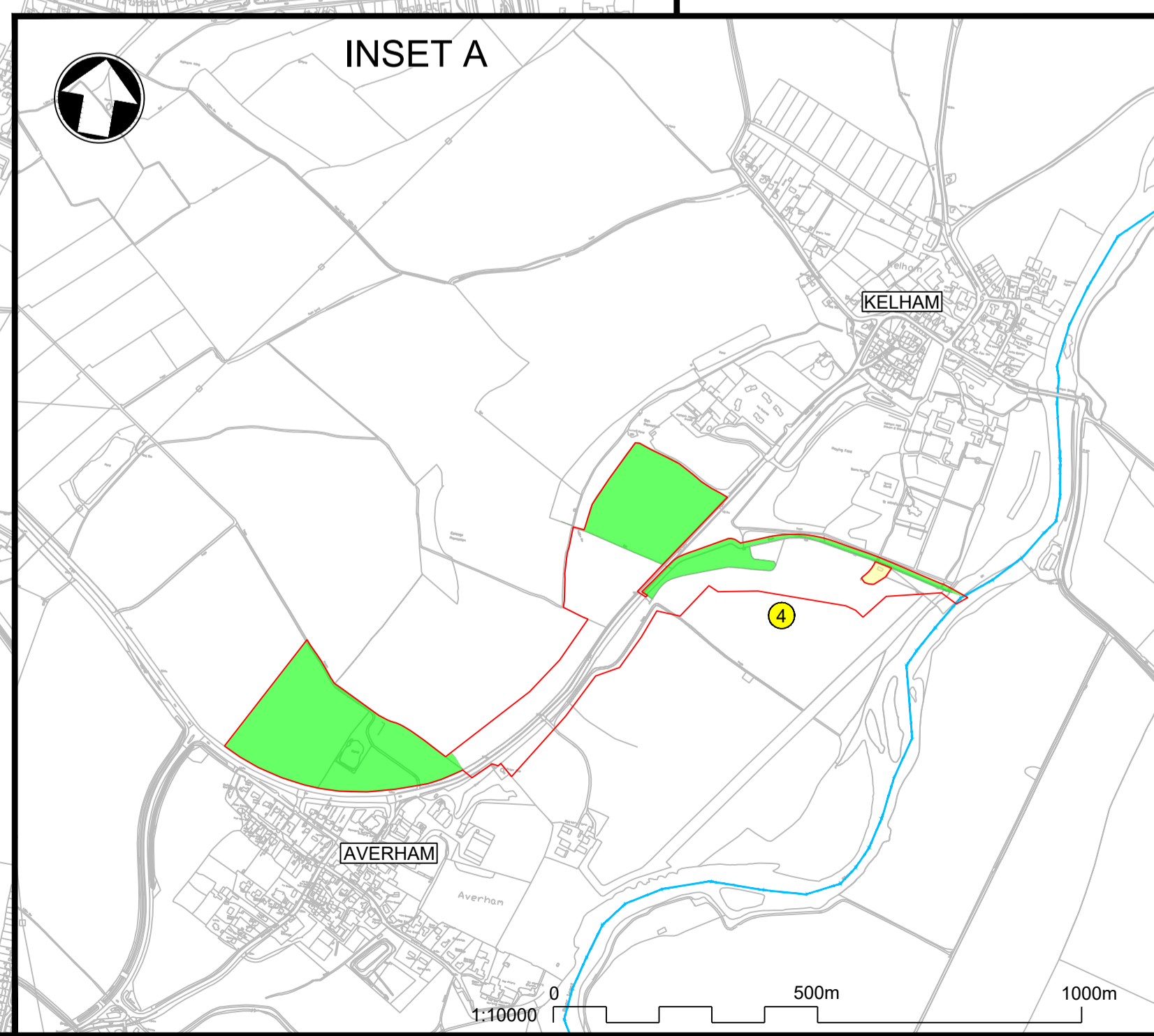

- Notes**
- Targeted consultation changes:**
- 1 Langford Hall access road**  
Following consultation feedback relating to impacted access routes, the proposed scheme boundary (also referred to as the 'draft Order Limits' or 'red line boundary') has been altered near Langford Hall. The design of the proposed access route is still in development, however additional land requirements have been identified.
  - 2 Winthorpe roundabout**  
Following consultation feedback and ongoing stakeholder engagement, the Winthorpe roundabout layout has been amended. To improve flows, the A46 traffic would be directed around the roundabout, with the northbound traffic from the Friendly Farmer roundabout passing through the middle. A signalled walking and cycling route would be provided across the junction between the A1133 and Drove Lane.
  - 3 Hargon Lane**  
Following consultation feedback, the proposed scheme boundary has been altered along part of Hargon Lane. This would enable any works and/or rights required to connect the current footpath on Hargon Lane with a new walking and cycling route proposed across Winthorpe roundabout between the A1133 and Drove Lane.
  - 4 Kelham/Averham floodplain compensation area**  
Following further design development and engagement with local stakeholders, the proposed scheme boundary has been altered to include new land parcels identified for use as floodplain compensation areas, including land within the Kelham Conservation Area.
  - 5 Farndon brideway (BW2) temporary diversion**  
Following consultation feedback, the proposed scheme boundary has been altered to enable an alternative route to be used as a temporary brideway diversion during construction.
  - 6 Farndon temporary construction holding area**  
Following feedback from local stakeholders, the proposed scheme boundary has been altered to include additional land for temporary use as a vehicle holding area during construction.

- General drawing notes:**
1. All dimensions are in metres unless otherwise stated.
  2. Land proposed to be acquired or used for the scheme permanently or temporarily is shown indicatively at this stage, with an appropriate level of confidence commensurate with the preliminary status of the design.
  3. This plan shows a draft of the preliminary design. Therefore this layout is subject to change.
  4. This plan shows the Draft Order Limits and highways design only. All other information has been omitted for clarity.

P01	10/03/23	FOR TARGETED CONSULTATION	RC	JS	RH
REV.	DATE	AMENDMENT DETAILS	ORIG	CHK'D	APP'D

Project's Promoter

Supported by

Drawing Status	Suitable for Review & Comment	Status	S3
----------------	-------------------------------	--------	----

Project Title  
**A46 Newark Bypass**

Drawing Title  
**Targeted Consultation Revised Draft Order Limits Plan**

Scale	1:10000	Designed	JS	Drawn	RC	Checked	JS	Approved	RH
Original Size	A1	Date	10/03/23	Date	10/03/23	Date	10/03/23	Date	10/03/23
Drawing Number	HE PIN	Originator	Volume	Project Ref. No.					
HE551478 - SKAG	- LLO -			HE551478					
CONWI_CONW	- DR - CH -	00002	Revision						
Location		Type	Role	Number	P01				

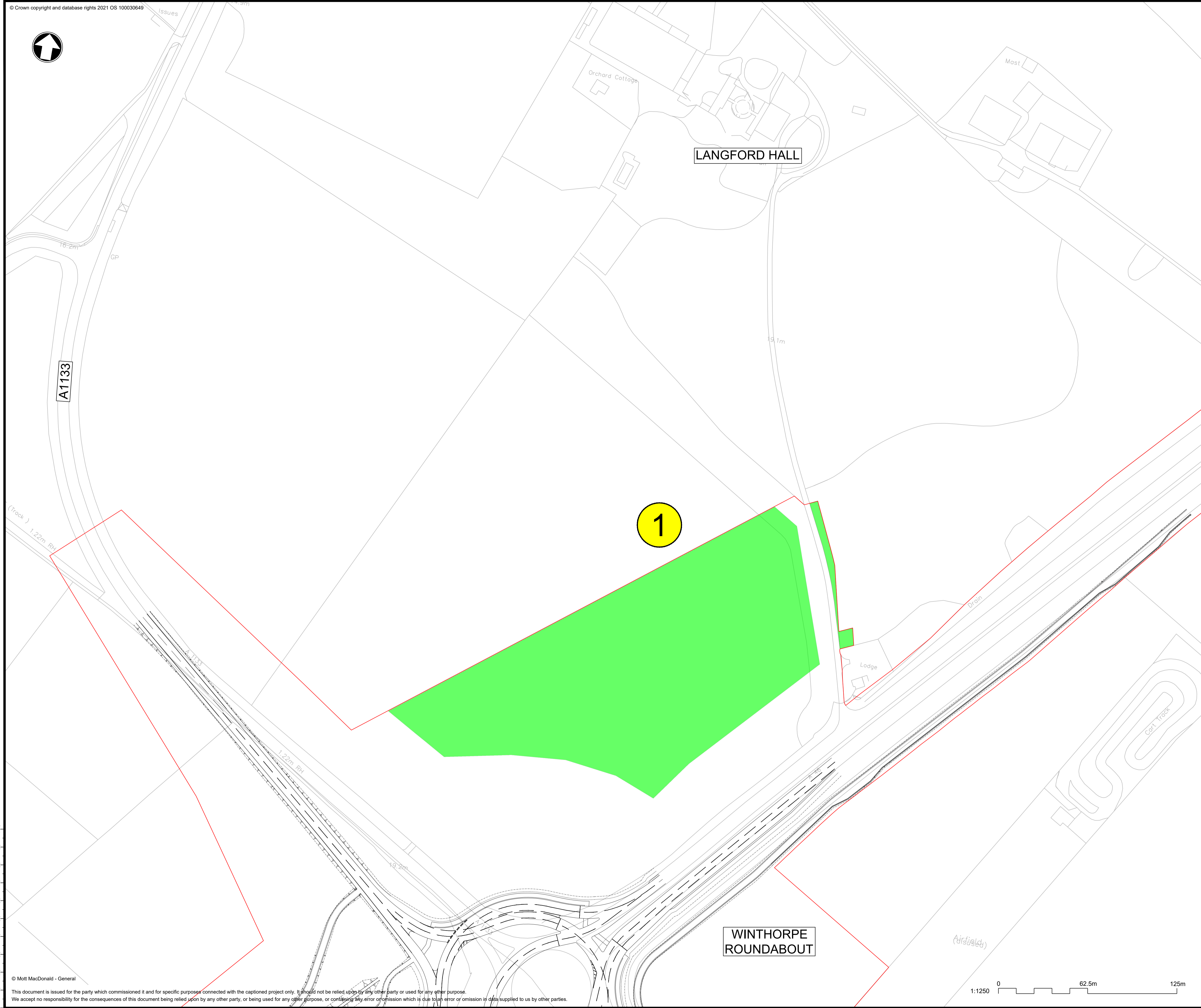

Notes

**Targeted consultation changes:**

- 1 Langford Hall access road

Following consultation feedback relating to impacted access routes, the proposed scheme boundary (also referred to as the 'draft Order Limits' or 'red line boundary') has been altered near Langford Hall. The design of the proposed access route is still in development, however additional land requirements have been identified.

**General drawing notes:**

- All dimensions are in metres unless otherwise stated.
- Land proposed to be acquired or used for the scheme permanently or temporarily is shown indicatively at this stage, with an appropriate level of confidence commensurate with the preliminary status of the design.
- This plan shows a draft of the preliminary design. Therefore this layout is subject to change.
- This plan shows the Draft Order Limits and highways design only. All other information has been omitted for clarity.

**Key:**

- Proposed Design Alignment
- Proposed Embankment
- Proposed Cutting
- Draft Order Limits (DOL) - Current
- DOL Additional Area

100  
90  
80  
70  
60  
50  
40  
30  
20  
10  
0

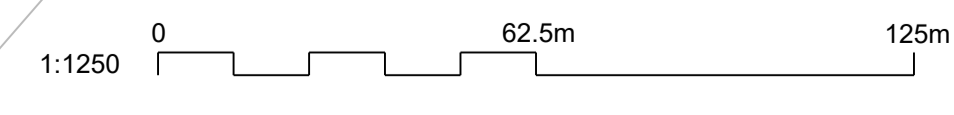

P01	10/03/23	FOR TARGETED CONSULTATION	RC	JS	RH
REV.	DATE	AMENDMENT DETAILS	ORIG	CHK'D	APP'D

Project's Promoter

Supported by

Drawing Status	Suitable for Review & Comment	Status	S3
----------------	-------------------------------	--------	----

Project Title  
**A46 Newark Bypass**

Drawing Title  
**Targeted Consultation  
Area Plan 1 - Langford Hall**

Scale	1:1250	Designed	JS	Drawn	RC	Checked	JS	Approved	RH
Original Size	A1	Date	10/03/23	Date	10/03/23	Date	10/03/23	Date	10/03/23
Drawing Number	HE551478	Originator	SKAG	Volume	LLO	Project Ref. No.		HE551478	
Location	SECT4_SECW	Type	DR	Role	CH	Number	00001	Revision	
								P01	

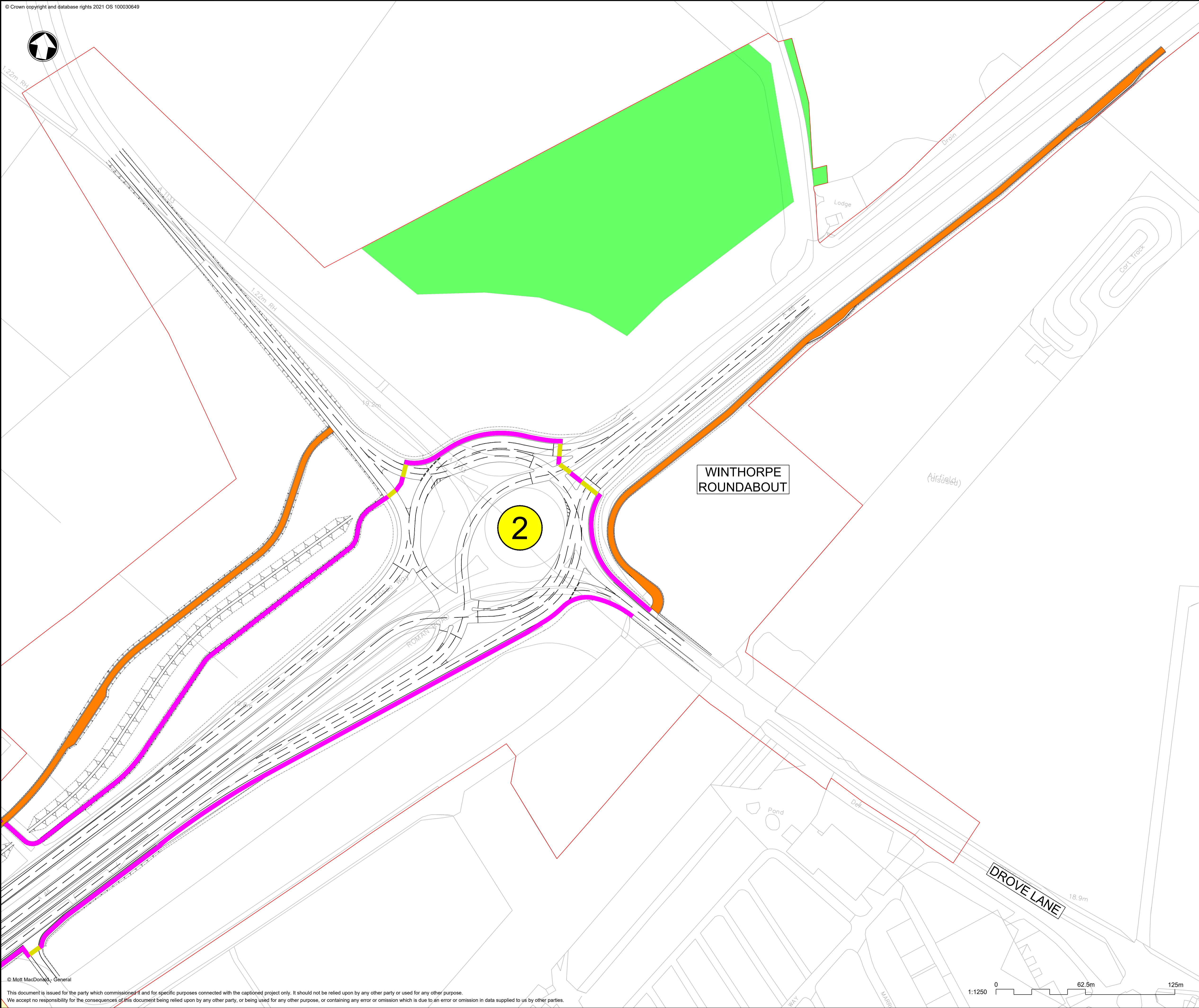

Notes

Targeted consultation changes:

2 Winthorpe roundabout  
 Following consultation feedback and ongoing stakeholder engagement, the Winthorpe roundabout layout has been amended. To improve flows, the A46 traffic would be directed around the roundabout, with the northbound traffic from the Friendly Farmer roundabout passing through the middle. A signalled walking and cycling route would be provided across the junction between the A1133 and Drove Lane.

General drawing notes:

- All dimensions are in metres unless otherwise stated.
- Land proposed to be acquired or used for the scheme permanently or temporarily is shown indicatively at this stage, with an appropriate level of confidence commensurate with the preliminary status of the design.
- This plan shows a draft of the preliminary design. Therefore this layout is subject to change.
- This plan shows the Draft Order Limits and highways design alongside proposals for the new walking and cycling routes. All other information has been omitted for clarity.

Key:

- Proposed Design Alignment
- Proposed Embankment
- Proposed Cutting
- Draft Order Limits (DOL) - Current
- DOL Additional Area
- Proposed Footway / Cycleway
- Proposed Pedestrian Crossing
- Proposed Accommodation Works Access Track

P01	10/03/23	FOR TARGETED CONSULTATION	RC	JS	RH
REV.	DATE	AMENDMENT DETAILS	ORIG	CHK'D	APP'D

Project's Promoter

Supported by

Drawing Status	Suitable for Review & Comment	Status	S3
----------------	-------------------------------	--------	----

Project Title  
**A46 Newark Bypass**

Drawing Title  
**Targeted Consultation  
 Area Plan 2 - Winthorpe Roundabout**

Scale	1:1250	Designed	JS	Drawn	RC	Checked	JS	Approved	RH
Original Size	A1	Date	10/03/23	Date	10/03/23	Date	10/03/23	Date	10/03/23

Drawing Number	HE PIN	Originator	Volume	Project Ref. No.
HE551478 - SKAG	- LLO -			HE551478
SECT4_SECW	- DR - CH -	00002		Revision
				P01

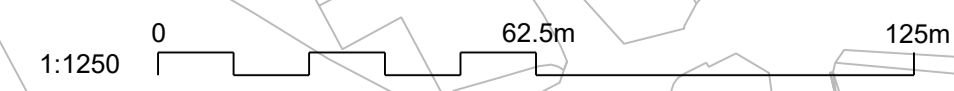

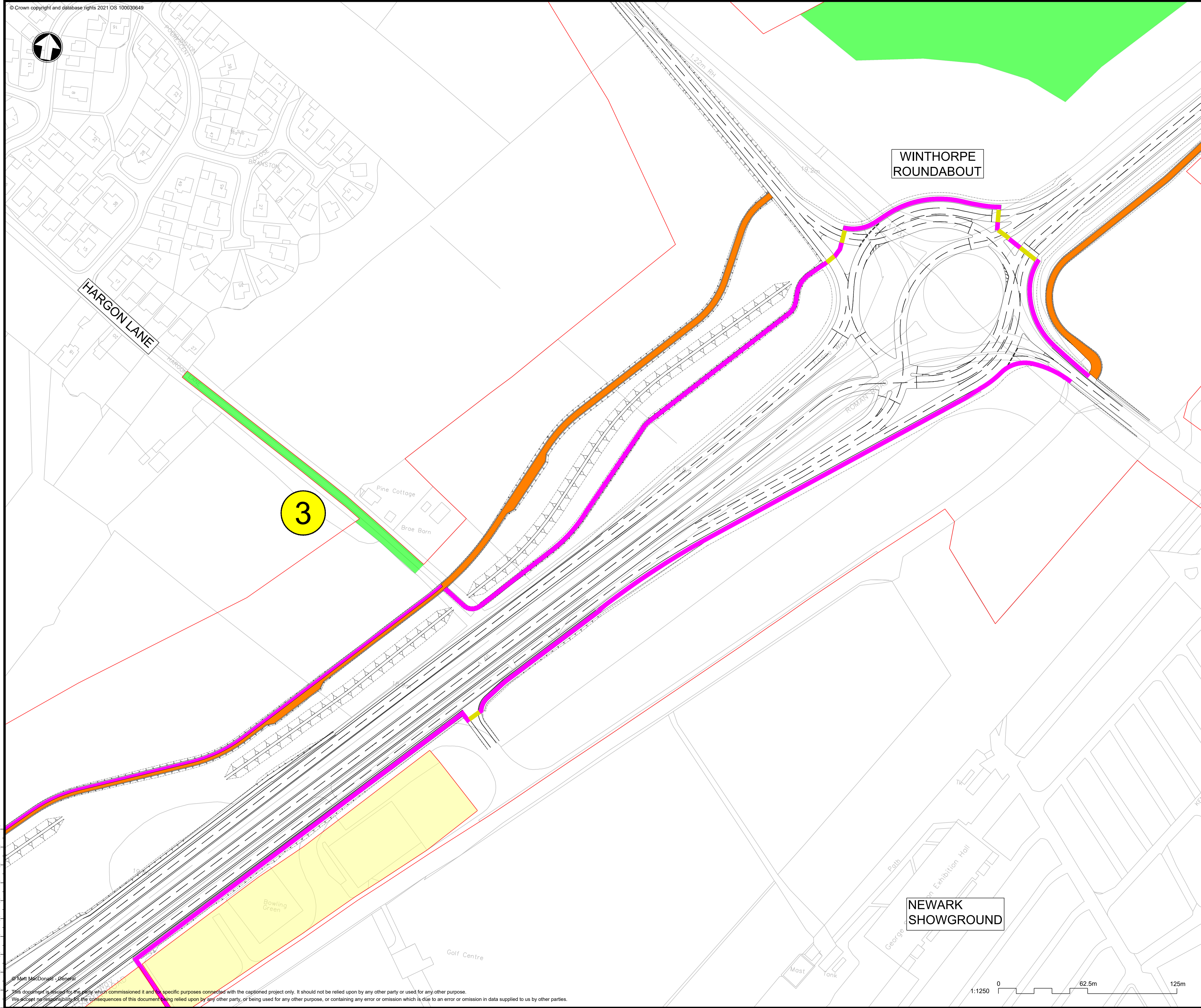

**Notes**

**Targeted consultation changes:**

③ **Hargon Lane**

Following consultation feedback, the proposed scheme boundary has been altered along part of Hargon Lane. This would enable any works and/or rights required to connect the current footpath on Hargon Lane with a new walking and cycling route proposed across Winthorpe roundabout between the A1133 and Drove Lane.

**General drawing notes:**

- All dimensions are in metres unless otherwise stated.
- Land proposed to be acquired or used for the scheme permanently or temporarily is shown indicatively at this stage, with an appropriate level of confidence commensurate with the preliminary status of the design.
- This plan shows a draft of the preliminary design. Therefore this layout is subject to change.
- This plan shows the Draft Order Limits and highways design alongside how Hargon Lane will connect with the wider proposed footways/cycleways. All other information has been omitted for clarity.

**Key:**

	Proposed Design Alignment
	Proposed Embankment
	Proposed Cutting
	Draft Order Limits (DOL) - Current
	DOL Additional Area
	DOL Exclusion Zone
	Proposed Footway / Cycleway
	Proposed Pedestrian Crossing
	Proposed Accommodation Works Access Track
	Proposed Combined Access Track / Footway / Cycleway

P01	10/03/23	FOR TARGETED CONSULTATION	RC	JS	RH
REV.	DATE	AMENDMENT DETAILS	ORIG	CHKD	APPD

Project's Promoter

Supported by

Drawing Status	Suitable for Review & Comment	Status	S3
----------------	-------------------------------	--------	----

Project Title

**A46 Newark Bypass**

Drawing Title

**Targeted Consultation Area Plan 3 - Hargon Lane**

Scale	1:1250	Designed	JS	Drawn	RC	Checked	JS	Approved	RH
Original Size	A1	Date	10/03/23	Date	10/03/23	Date	10/03/23	Date	10/03/23
Drawing Number	HE PIN	Originator	SKAG	Volume	LLO	Project Ref. No. HE551478			
Location	SECT4_SECW	Type	DR	Role	CH	Number	00003	Revision	P01

This document is issued for the party which commissioned it and for specific purposes connected with the captioned project only. It should not be relied upon by any other party or used for any other purpose. We accept no responsibility for the consequences of this document being relied upon by any other party, or being used for any other purpose, or containing any error or omission which is due to an error or omission in data supplied to us by other parties.

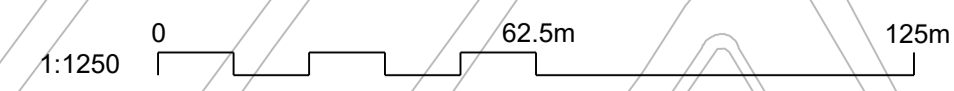

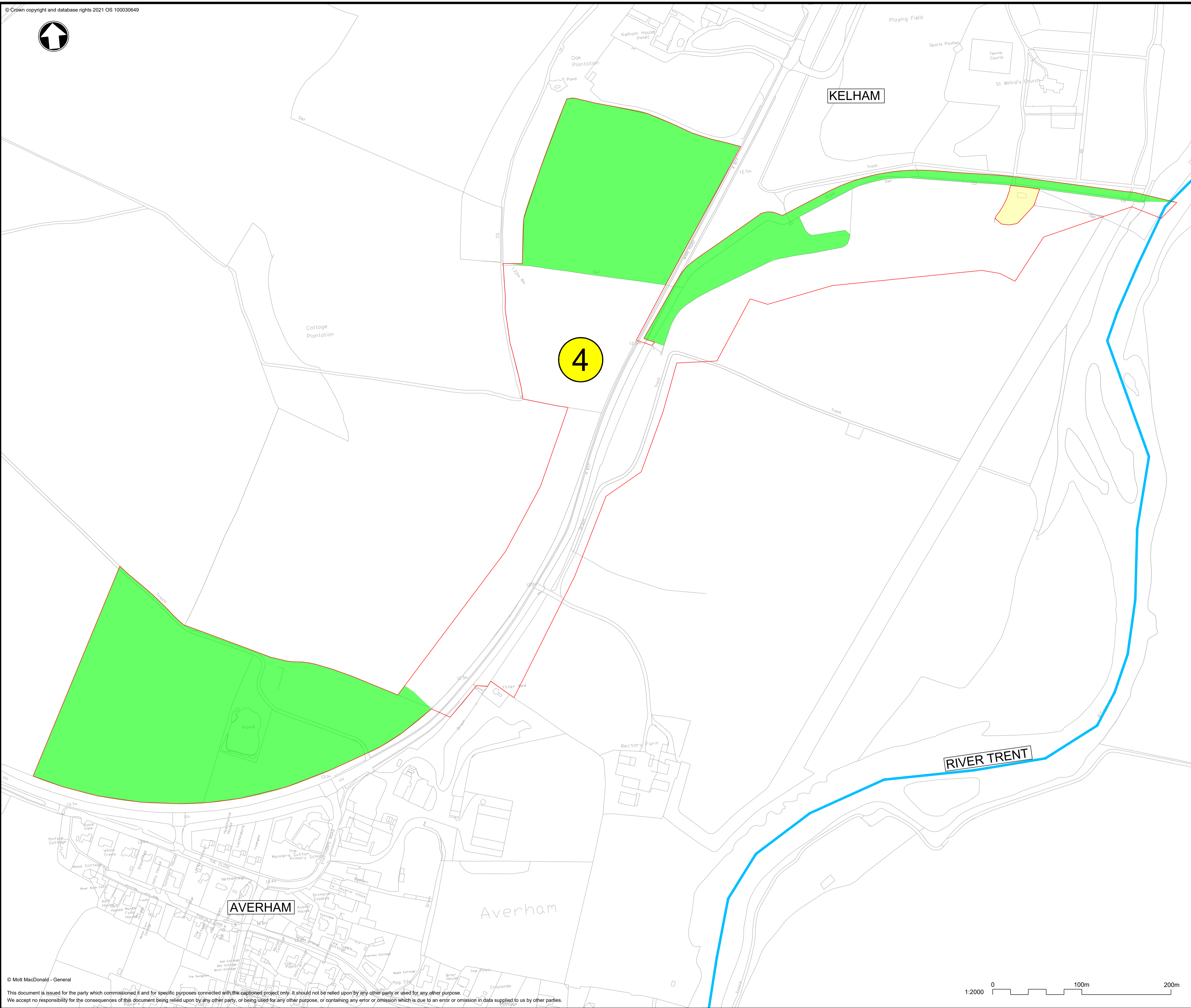

Notes

**Targeted consultation changes:**  
**Kelham/Averham floodplain compensation area**  
 Following further design development and engagement with local stakeholders, the proposed scheme boundary has been altered to include new land parcels identified for use as floodplain compensation areas, including land within the Kelham Conservation Area.

- General drawing notes:
- All dimensions are in metres unless otherwise stated.
  - Land proposed to be acquired or used for the scheme permanently or temporarily is shown indicatively at this stage, with an appropriate level of confidence commensurate with the preliminary status of the design.
  - This plan shows a draft of the preliminary design. Therefore this layout is subject to change.
  - This plan shows the Draft Order Limits and highways design only. All other information has been omitted for clarity.

Key:

	Proposed Design Alignment
	Proposed Embankment
	Proposed Cutting
	Draft Order Limits (DOL) - Current
	DOL Additional Area
	River Trent
	DOL Exclusion Zone

P01	10/03/23	FOR TARGETED CONSULTATION	RC	JS	RH
REV.	DATE	AMENDMENT DETAILS	ORIG	CHK'D	APP'D

Project's Promoter

Supported by

Drawing Status	Suitable for Review & Comment	Status	S3
----------------	-------------------------------	--------	----

Project Title  
**A46 Newark Bypass**

Drawing Title  
**Targeted Consultation  
 Area Plan 4 - Kelham/Averham  
 Floodplain Compensation Area**

Scale	1:2000	Designed	JS	Drawn	RC	Checked	JS	Approved	RH
Original Size	A1	Date	10/03/23	Date	10/03/23	Date	10/03/23	Date	10/03/23
Drawing Number	HE551478 - SKAG	Originator	- LLO -	Volume		Project Ref. No.		HE551478	
Location	CONWI_CONW	Type	DR - CH	Number	00003	Revision		P01	

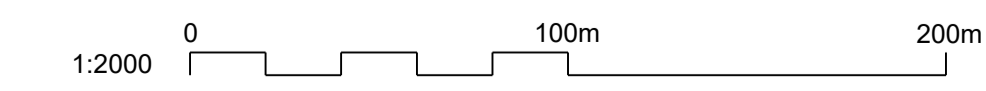



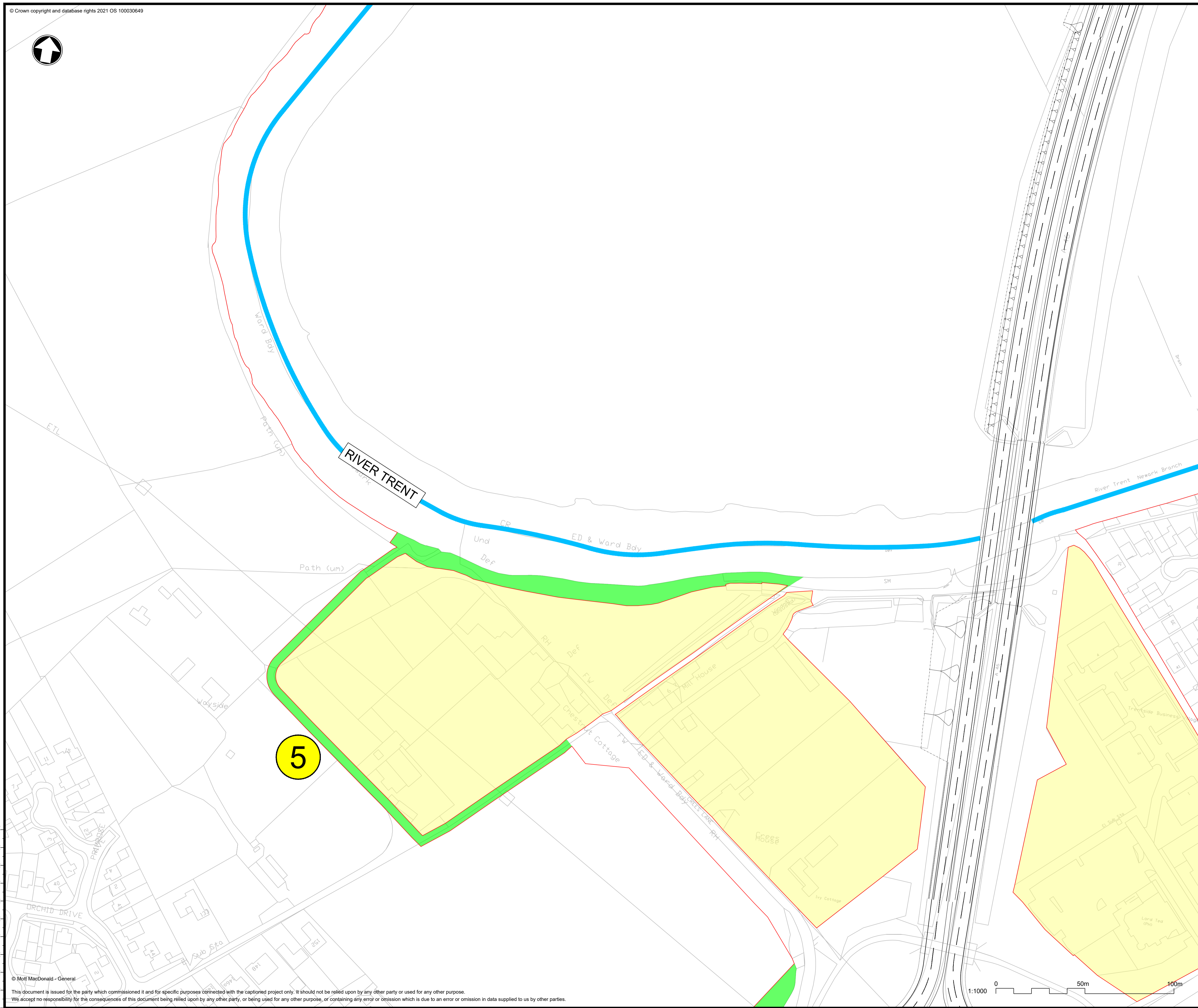

Notes

**Targeted consultation changes:**

5 Farndon bridlway (BW2) temporary diversion

Following consultation feedback, the proposed scheme boundary has been altered to enable an alternative route to be used as a temporary bridlway diversion during construction.

**General drawing notes:**

- All dimensions are in metres unless otherwise stated.
- Land proposed to be acquired or used for the scheme permanently or temporarily is shown indicatively at this stage, with an appropriate level of confidence commensurate with the preliminary status of the design.
- This plan shows a draft of the preliminary design. Therefore this layout is subject to change.
- This plan shows the Draft Order Limits and highways design only. All other information has been omitted for clarity.

**Key:**

- Proposed Design Alignment
- Proposed Embankment
- Proposed Cutting
- Draft Order Limits (DOL) - Current
- DOL Additional Area
- DOL Exclusion Zone
- River Trent

P01	10/03/23	FOR TARGETED CONSULTATION	RC	JS	RH
REV.	DATE	AMENDMENT DETAILS	ORIG	CHK'D	APP'D

Project's Promoter

Supported by

Drawing Status	Suitable for Review & Comment	Status	S3
----------------	-------------------------------	--------	----

Project Title

**A46 Newark Bypass**

Drawing Title

**Targeted Consultation  
Area Plan 5 - Farndon Bridlway (BW2)  
Temporary Diversion**

Scale	1:1000	Designed	JS	Drawn	RC	Checked	JS	Approved	RH
Original Size	A1	Date	10/03/23	Date	10/03/23	Date	10/03/23	Date	10/03/23

Drawing Number	HE551478 - SKAG	Originator	- LLO -	Volume		Project Ref. No.	HE551478
Location	SECT1_SECW	Type	- DR - CH -	Number	00001	Revision	P01

100  
90  
80  
70  
60  
50  
40  
30  
20  
10



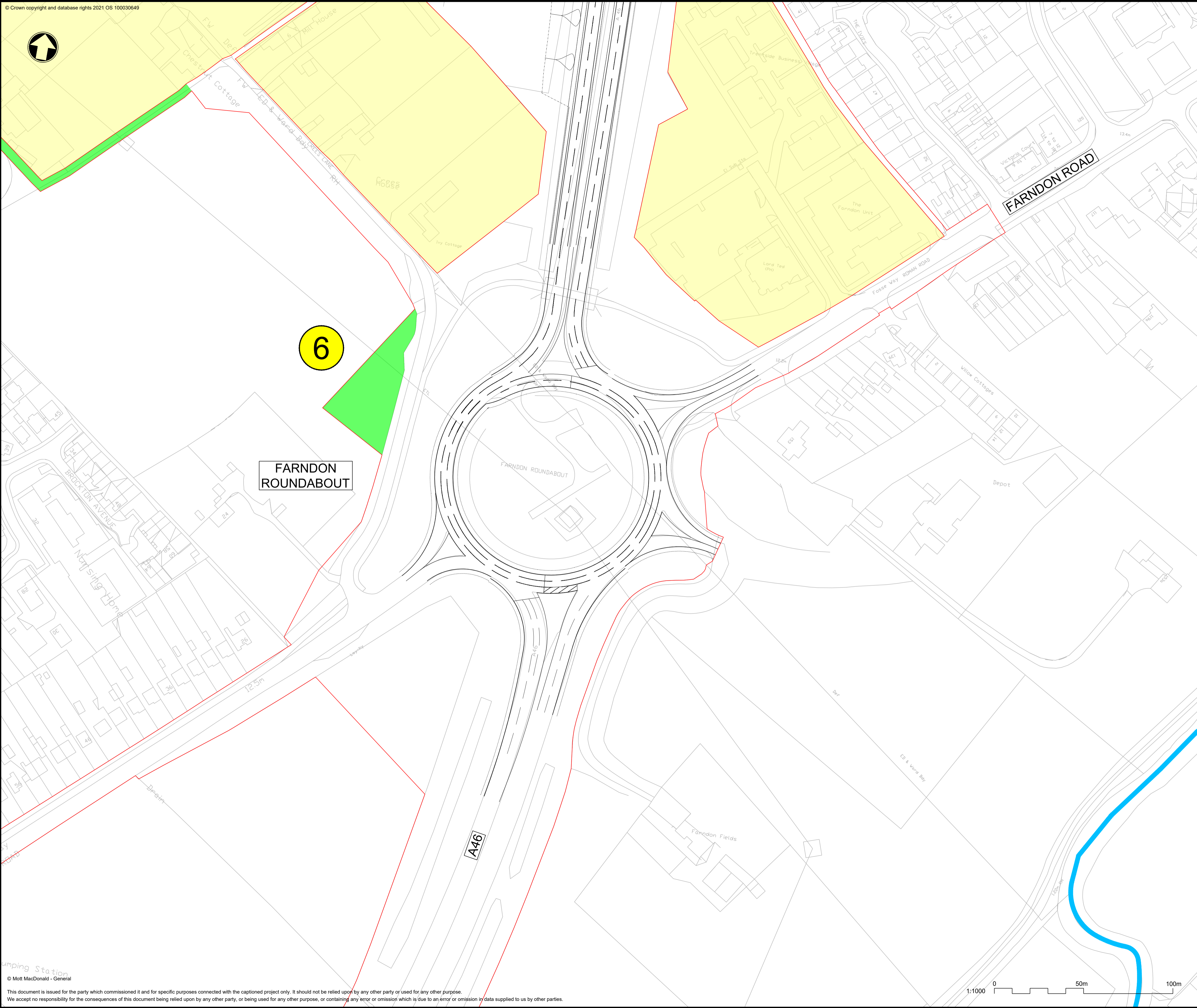

Notes

**Targeted consultation changes:**

6 Farndon temporary construction holding area

Following feedback from local stakeholders, the proposed scheme boundary has been altered to include additional land for temporary use as a vehicle holding area during construction.

**General drawing notes:**

- All dimensions are in metres unless otherwise stated.
- Land proposed to be acquired or used for the scheme permanently or temporarily is shown indicatively at this stage, with an appropriate level of confidence commensurate with the preliminary status of the design.
- This plan shows a draft of the preliminary design. Therefore this layout is subject to change.
- This plan shows the Draft Order Limits and highways design only. All other information has been omitted for clarity.

**Key:**

	Proposed Design Alignment
	Proposed Embankment
	Proposed Cutting
	Draft Order Limits (DOL) - Current
	DOL Additional Area
	DOL Exclusion Zone
	River Trent

100  
90  
80  
70  
60  
50  
40  
30  
20  
10  
0

12.5m

1:1000

0 50m 100m

© Mott MacDonald - General

This document is issued for the party which commissioned it and for specific purposes connected with the captioned project only. It should not be relied upon by any other party or used for any other purpose. We accept no responsibility for the consequences of this document being relied upon by any other party, or being used for any other purpose, or containing any error or omission which is due to an error or omission in data supplied to us by other parties.

P01	10/03/23	FOR TARGETED CONSULTATION	RC	JS	RH
REV.	DATE	AMENDMENT DETAILS	ORIG	CHK'D	APP'D
Project's Promoter					
Supported by					
Drawing Status					Status
Suitable for Review & Comment					S3
Project Title					
A46 Newark Bypass					
Drawing Title					
Targeted Consultation Area Plan 6 - Farndon Temporary Construction Holding Area					
Scale	Designed	Drawn	Checked	Approved	
1:1000	JS	RC	JS	RH	
Original Size	Date	Date	Date	Date	
A1	10/03/23	10/03/23	10/03/23	10/03/23	
Drawing Number	Originator	Volume	Project Ref. No.		
HE PIN	SKAG	- LLO -	HE551478		
SECT1_SECW - DR - CH - 00002			Revision		
Location   Type   Role   Number			P01		